



THE  
RESIDENCES  
THREE SIXTY

sector 70A  
GURUGRAM

LIVE FRESH

# Breathe fresh



THE  
RESIDENCES  
THREE SIXTY





ARTISTIC IMPRESSION



THE  
RESIDENCES  
THREE SIXTY



## THE RESIDENCES THREE SIXTY

The Residences Three Sixty is a collection of 2 & 3 BHK new-age homes surrounded by scenic views and a multitude of world-class amenities located just around the corner. Located conveniently in Sector 71-A of Gurugram, it gives you an easy and quick access to commercial hubs, schools, healthcare centres and corporate hubs.

With the city's smart infrastructure around, The Residences Three Sixty allows you to experience an exclusive lifestyle within and outside the complex.





  
THE  
RESIDENCES  
THREE SIXTY



# The location

Situated at one of the most strategic locations of the millennium city, your commute to and from your home will be a breeze. Apart from offering effortless connectivity, robust infrastructure offers pleasant commuting in all seasons.

---

**CONNECTED TO  
NH 8 &  
DELHI-JAIPUR  
HIGHWAY**

**PREMIUM  
GOLF COURSE EXT RD  
NEARBY**

**10 MINS TO  
HUDA CITY  
CENTRE**

---



THE  
RESIDENCES  
THREE SIXTY

LIVE LIFE TO  
*fullest*





The Residences 360 are optimally planned homes to accommodate the needs of all your family members. Be it a jogging track, sit-outs for senior citizens, secured play areas for kid's or party zones for adults, you will never ask for more.



## THE OUTDOORS



## EXPERIENCES



It is your chance to immerse yourself in the greener, safer and active world, just outside the threshold of your home. Engage yourself in the lifestyle and health enhancing activities.



## THE ACTIVE LIFE

These exclusive residences give you a chance to connect with your inner self through best of the activities in the most pristine surroundings. With plush outdoors and activity areas for everyone in the family, embrace an active life.





THE  
RESIDENCES  
THREE SIXTY







HIGHEST LEVEL OF  
*comfort*  
AND *luxury*

  
THE  
RESIDENCES  
THREE SIXTY



THE INSIDE

**2 BHK**  
**3 BHK**  
**PENTHOUSES**

The residences introduce you to a new world of aesthetics and comforts. The interiors of these premium homes, being a part of your daily life, are conceptualised to seamlessly blend into your routine and enhance your mood along with your lifestyle.





**WELL LIT APARTMENTS**  
**SUN - KISSED BALCONIES**  
**OPTIMUM SPACE UTILISATION**



## THE SPACES

These residences are a perfect blend of inside harmony to the outside world. Being flawlessly crafted, it transports you into complete peace of mind where elegance, luxury and amenities meet.





YOUR  
*home*

YOUR

YOUR

*world*





THE  
RESIDENCES  
THREE SIXTY





# LOCATION MAP

(Map not to scale)



  
**THE  
RESIDENCES**  
THREE SIXTY





THE  
RESIDENCES  
THREE SIXTY



  
**THE**
  
**RESIDENCES**
  
 THREE SIXTY



**THE SITE PLAN**

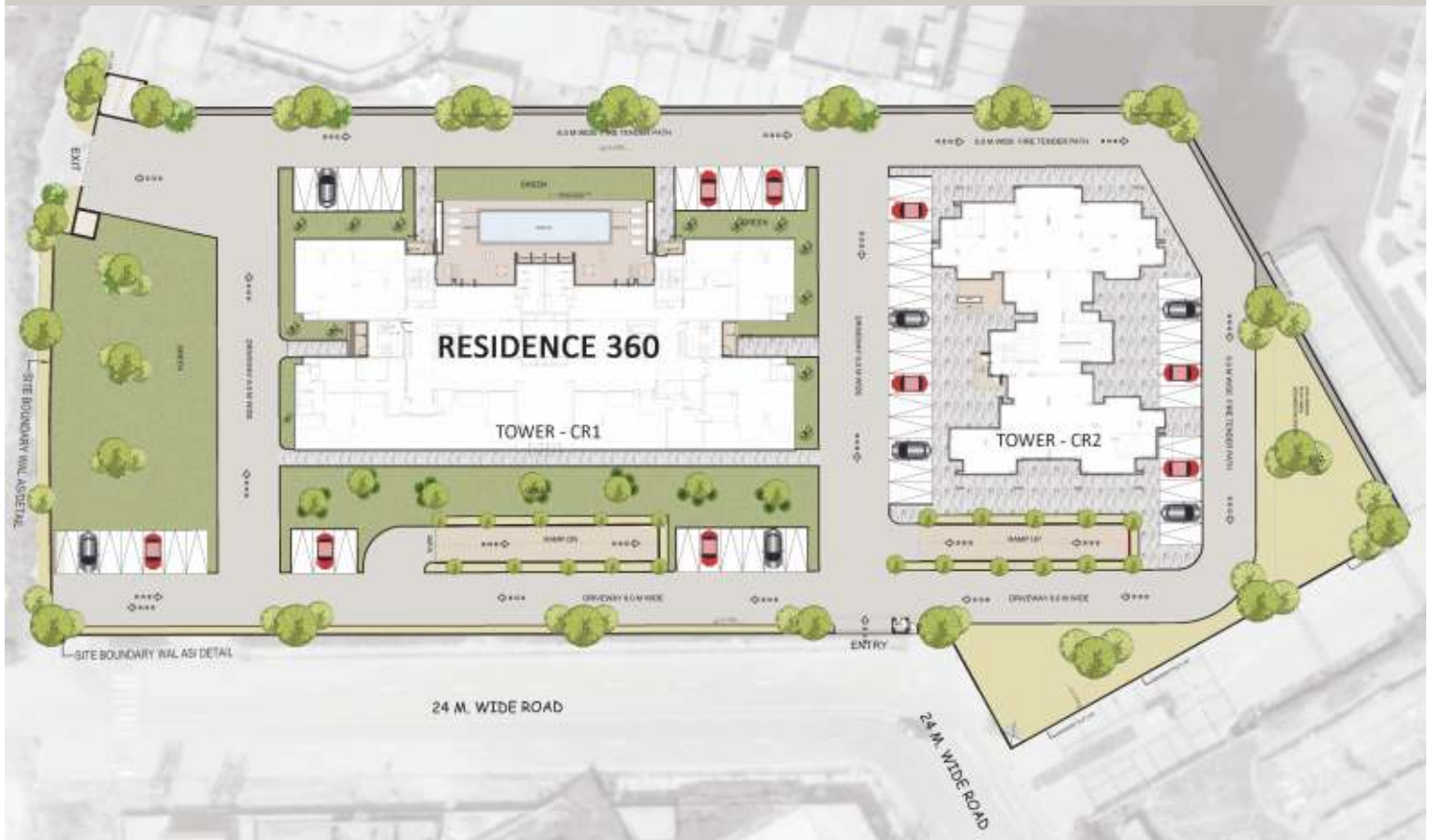



## FLOOR PLANS - APARTMENTS

### TYPE 01 : 1976 SQ. FT. (183.5 SQ. MTR.)

TYPICAL FLOOR PLAN

3 BEDROOMS + 3 BATHROOMS + S. ROOM

[ SUPER AREA 1976 SQ. FT. | CARPET AREA: 1251 SQ. FT. | BALCONY AREA 462 SQ. FT. ]



### TYPE 02 : 1450 SQ. FT. (135 SQ. MTR.)

TYPICAL FLOOR PLAN

2 BEDROOMS + 2 BATHROOMS

[ SUPER AREA 1450 SQ. FT. | CARPET AREA: 900 SQ. FT. | BALCONY AREA 316 SQ. FT. ]







# THE SPECIFICATIONS



## LIVING ROOM / DINING / FAMILY LOUNGE

WALLS	POP punning with emulsion paint.
FLOOR	Vitrified Tile flooring of kajaria or equivalent.
CEILING	Pop + emulsion paint.
DOORS	Flush door with laminate of merino & Hardware Fitting of IPSA/Ozone or equivalent.
WINDOWS / GLAZING	UPVC window frames with clear toughened glass.

## MASTER BEDROOM

WALLS	POP punning with emulsion paint.
FLOOR	High Grade Laminated Wooden flooring and wooden skirting.
CEILING	Pop + emulsion paint.
DOORS	Flush door with laminate & Hardware Fitting.
WINDOWS / GLAZING	UPVC window frames with clear toughened glass.

## OTHER BEDROOMS

WALLS	POP punning with emulsion paint
FLOOR	Vitrified Tile flooring of kajaria or equivalent.
CEILING	Pop + emulsion paint.
DOORS	Flush door with laminate of merino & Hardware Fitting of IPSA/Ozone or equivalent.
WINDOW / GLAZING	UPVC window frames with clear toughened glass.

## KITCHEN

WALLS	Combination of tiles upto 2' -0" above the counter and emulsion in the balance areas.
FLOOR	Vitrified Tile flooring of kajaria or equivalent.
CEILING	Pop + emulsion paint.
DOORS	Flush door with laminate of merino & Hardware Fitting of IPSA/Ozone or equivalent.
WINDOWS / GLAZING	UPVC window frames with clear toughened glass.

## BALCONIES / TERRACES

WALLS	M.S. railing with handrail
FLOOR	Anti-skid tiles .
CEILING	Weather-proof paint
DOORS	Doors in UPVC / Aluminum powder coated frames
WINDOWS / GLAZING	UPVC / powder coated aluminum window frames with clear glass.



# THE SPECIFICATIONS



## MASTER TOILET

WALLS	Vitrified Tile flooring of kajaria or equivalent
FLOOR	Vitrified Tile flooring of kajaria or equivalent
CEILING	POP + emulsion paint
DOORS	Flush door with laminate of merino & Hardware Fitting of IPSA/Ozone or equivalent.
WINDOWS / GLAZING	UPVC / powder coated aluminum window frames with clear glass.
TOILET SANITARY FITTINGS	Toilet fittings of Roca/Kohler or equivalent.

## OTHER TOILET

WALLS	Vitrified Tile flooring of kajaria or equivalent
FLOOR	Vitrified Tile flooring of kajaria or equivalent
CEILING	POP + emulsion paint
DOORS	Flush door with laminate of merino & Hardware Fitting of IPSA/Ozone or equivalent.
WINDOWS / GLAZING	UPVC / powder coated aluminum window frames with clear / frosted/tinted glass

## S. ROOM/ UTILITY

WALLS	Oil Bound distemper paint
FLOOR	Ceramic tile flooring tile flooring of kajaria or equivalent
CEILING	Oil Bound distemper paint
DOORS	Flush door with laminate of merino & Hardware Fitting of IPSA/Ozone or equivalent.
WINDOW / GLAZING	UPVC window with clear glass

## LIFT LOBBY, CORRIDOR

WALLS	Granite Stone in Flooring and Texture paint on wall with SS Jambs and Lift Facia Tile/Stone Cladding
-------	--

## EXTERNAL HARD FINISH TEXTURE PAINT

WALLS	Texture paint of Asian/Acro/Dulux or equivalent.
-------	--

## STAIR CASE

WALLS	Granite/Kota stone & M.S. railing with handrail
-------	---

## HVAC

3 BHK	1.5 Ton 3*AC-Bedroom-3 Nos. AND 2 Ton 3*AC-Living-1 No.
-------	---

2 BHK	1.5 Ton 3*AC-Bedroom-2 Nos. AND 2 Ton 3*AC-Living-1 No.
-------	---

## HVAC

Outdoor Porch / Courtyard	Combination of Plants, Powers & Grit finish floor as per architect / landscape consultant
---------------------------	---



## ABOUT US

# CAPITAL™

## IT & ITES COMMERCIAL RESIDENTIAL

Capital, since the last three decades, has consistently achieved remarkable results for its patrons; seeking to invest in futuristic and trustworthy realty. With our innovative and client focussed strategies, we have been able to secure high returns on their investments. Our key strength being construction, we always strive to accomplish things for our clients that have never been experienced before.

## FEW OF OUR PROJECTS



**SKYMARK ONE**  
NOIDA



**CYBERSCAPE**  
SEC 59 • GURUGRAM



**CITYSCAPE**  
SEC 66 • GURUGRAM



**CAPITAL  
BUSINESS PARK**  
SEC 48 • GURUGRAM





**THE  
RESIDENCES**  
THREE SIXTY

Capital Developers

Veritas Building, 4th Floor

Golf Course Road, Sector-53

Gurgaon-122002